



....how the process of engaging with the original designer has influenced, enriched and sustained the SOH as a heritage place....

Susan Macdonald







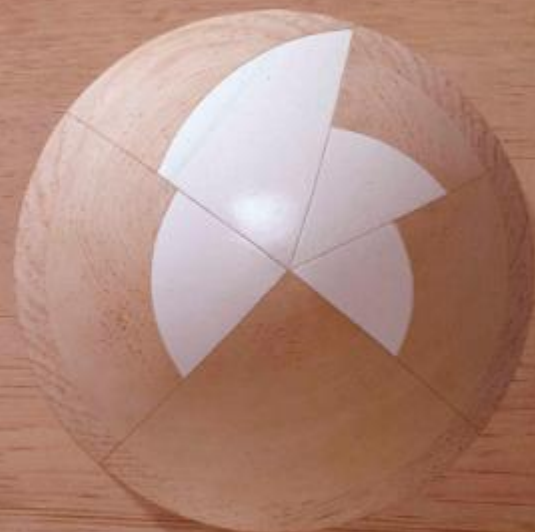





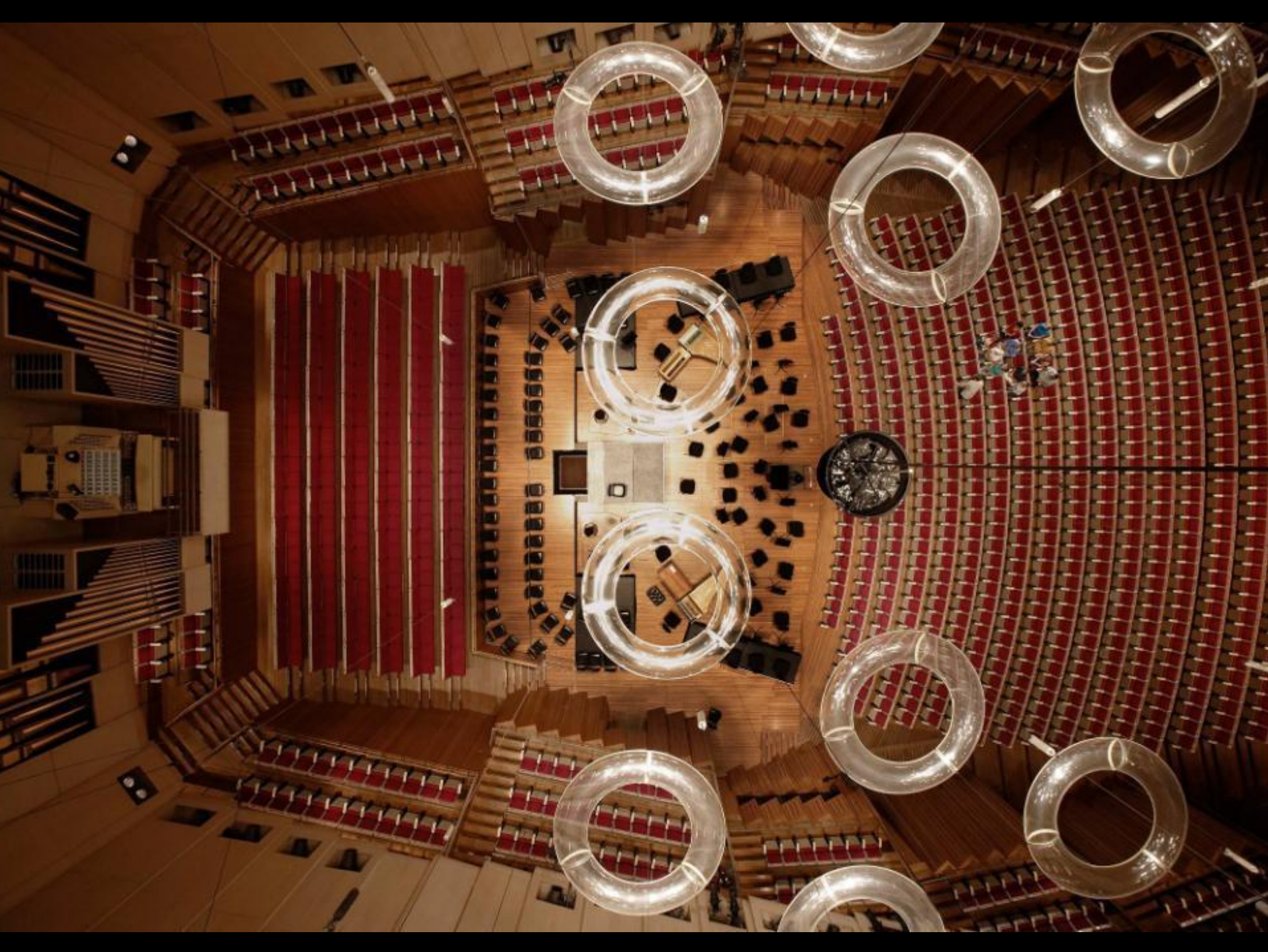



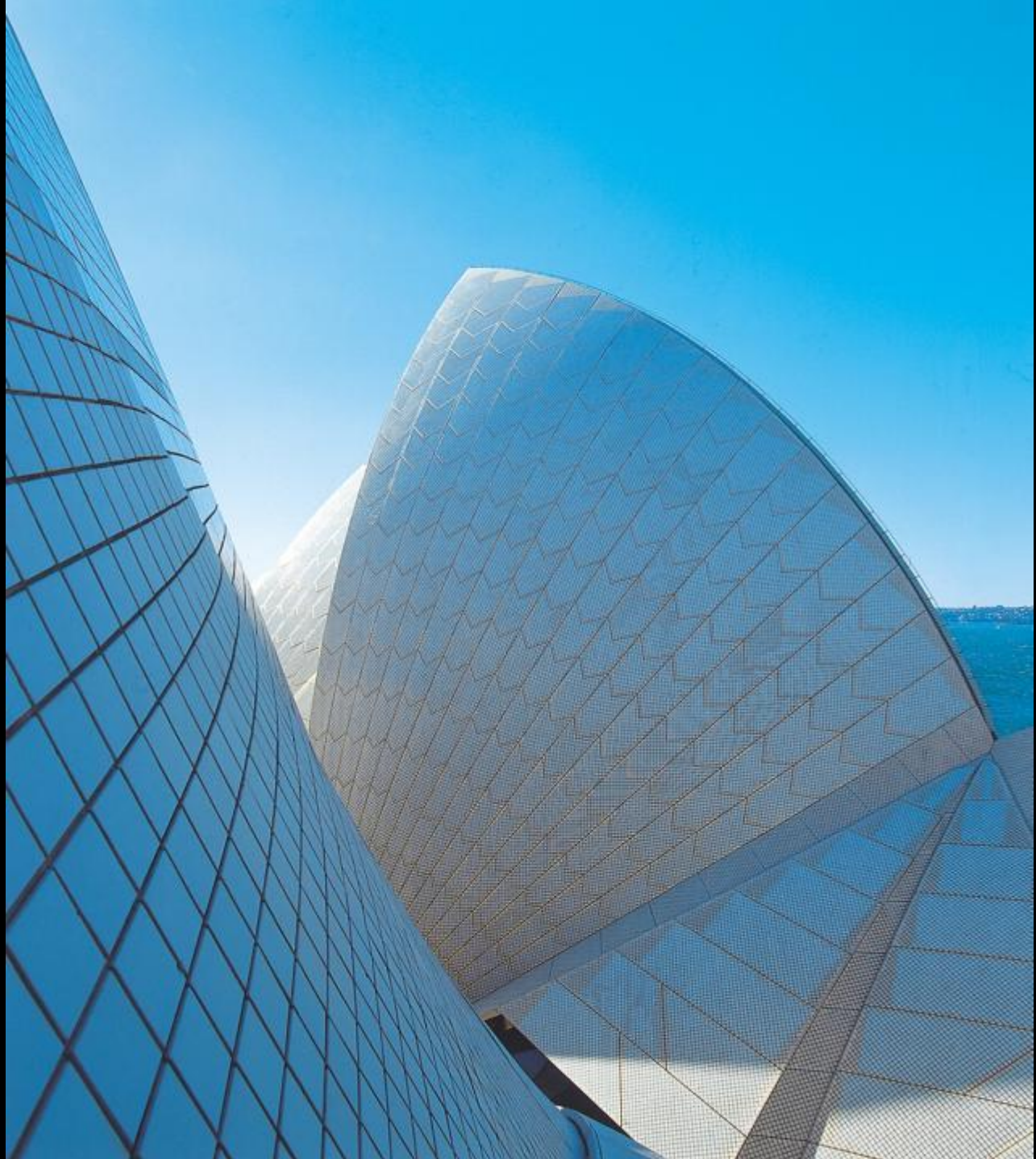









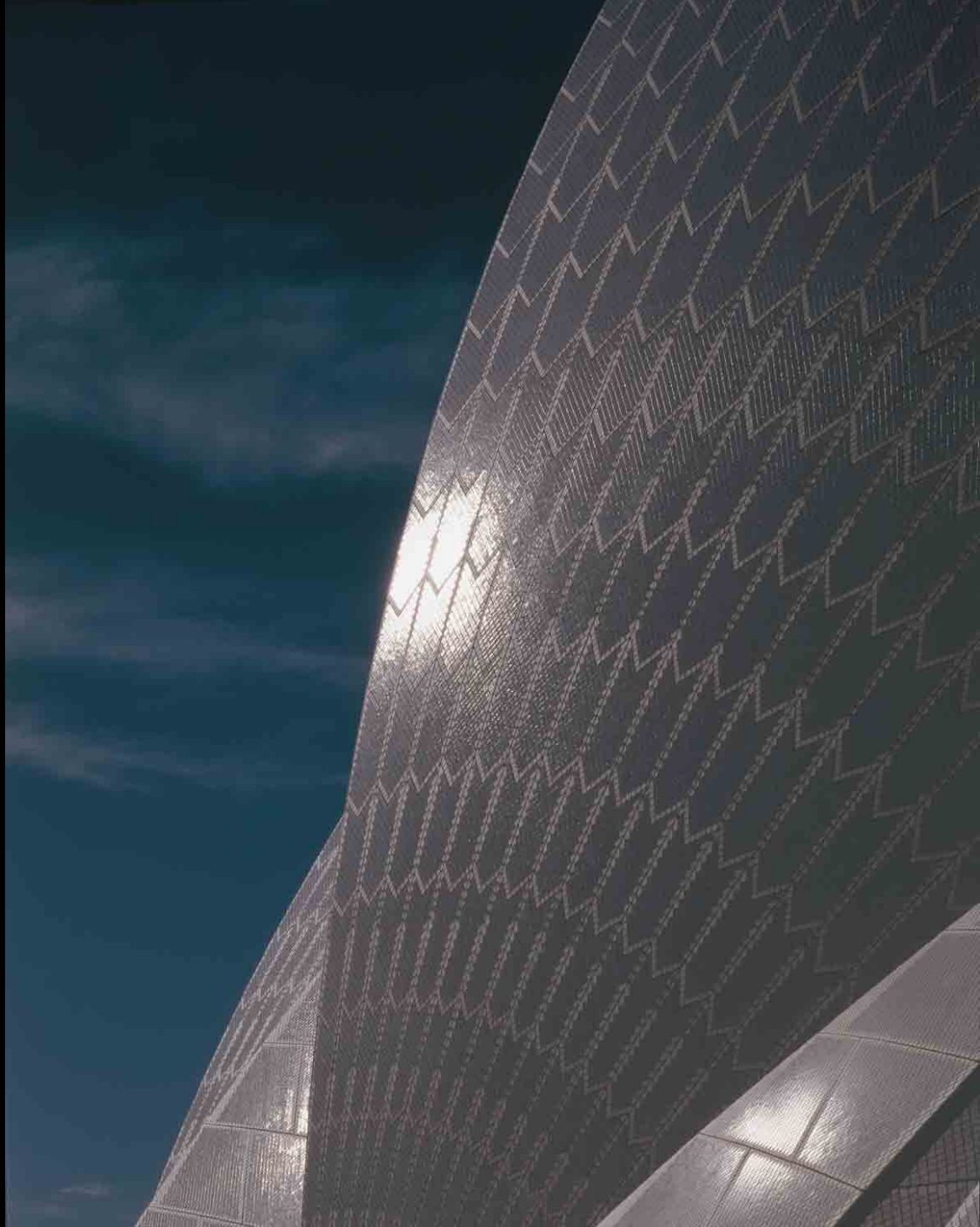







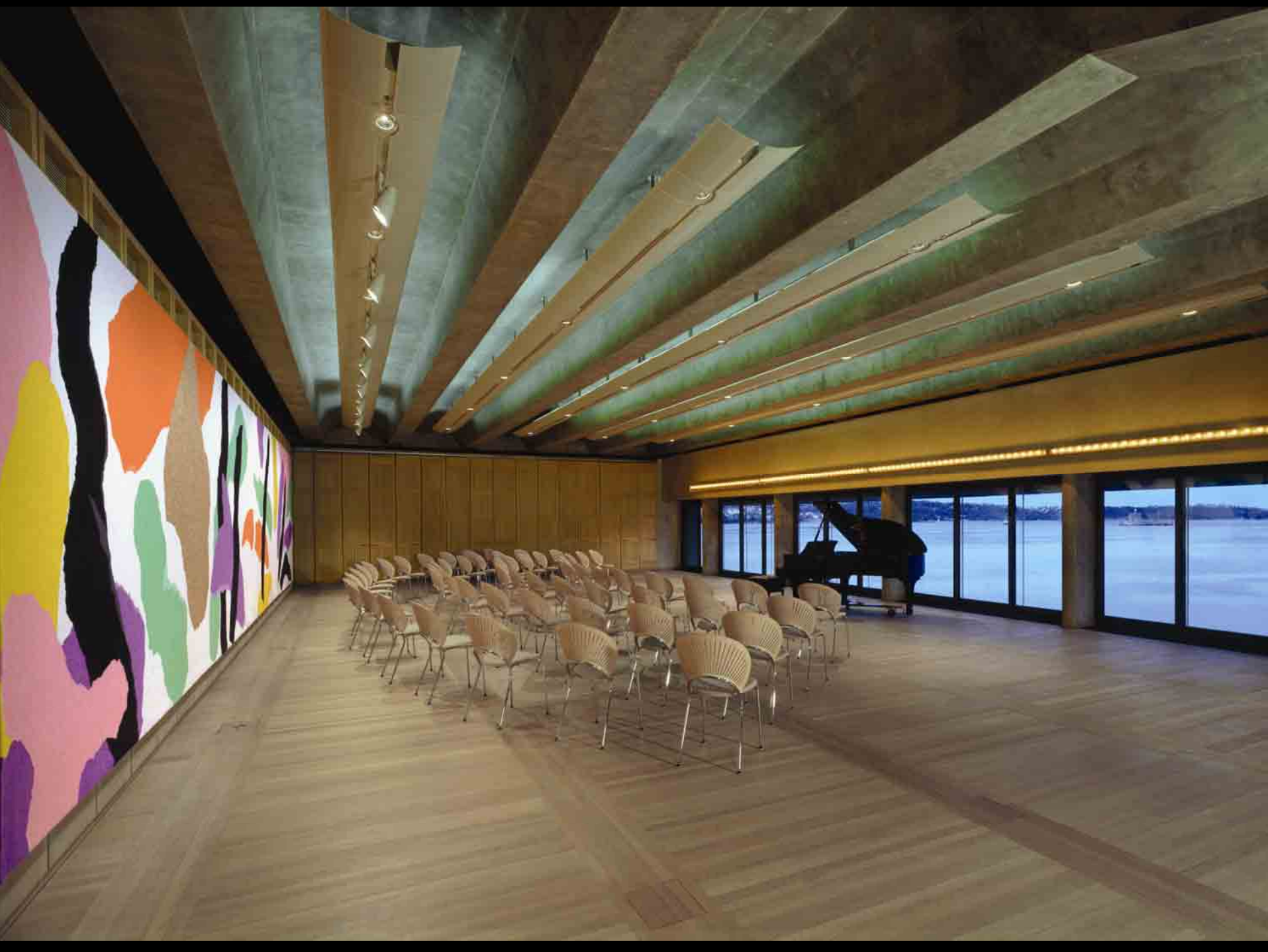







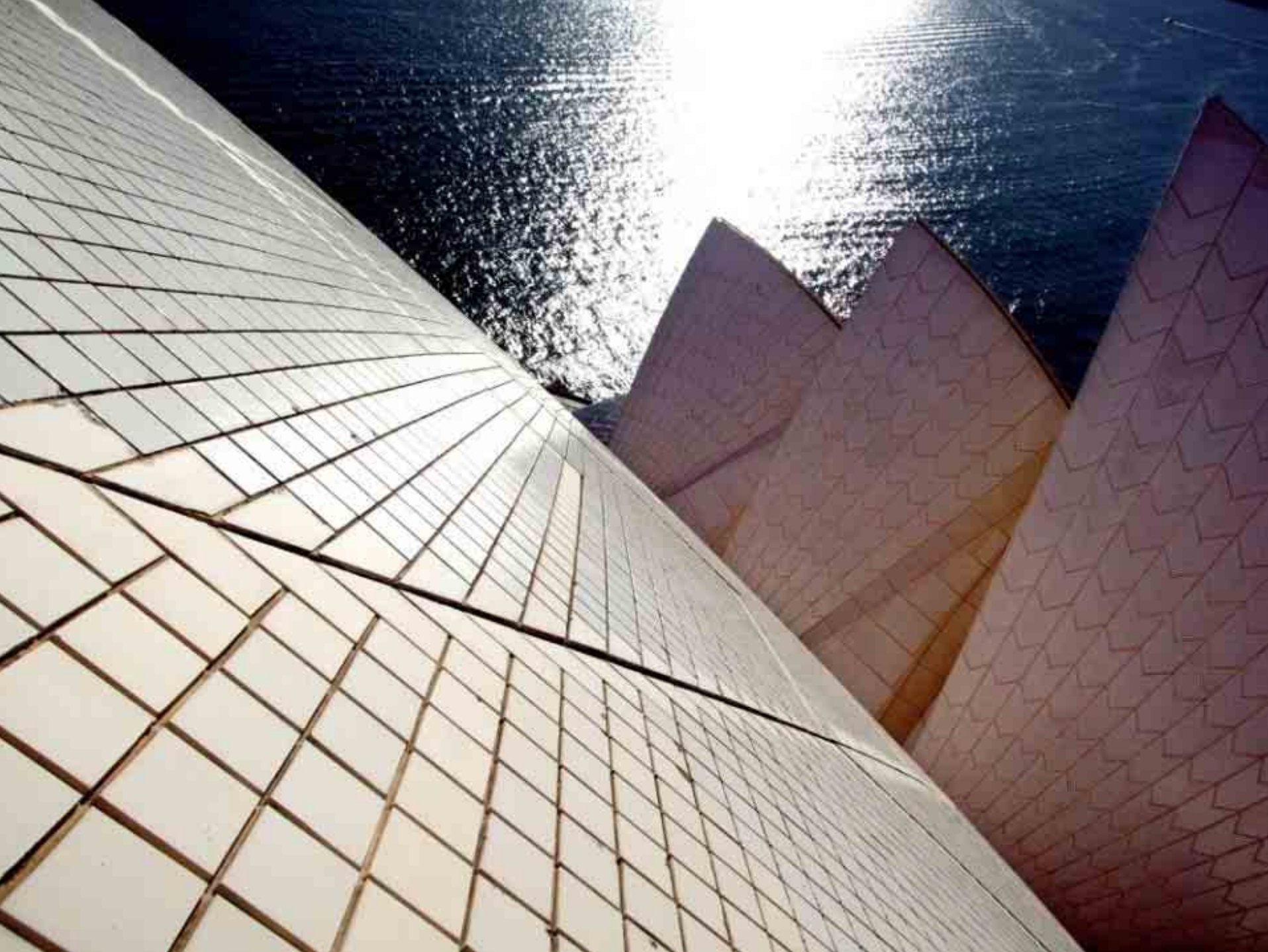































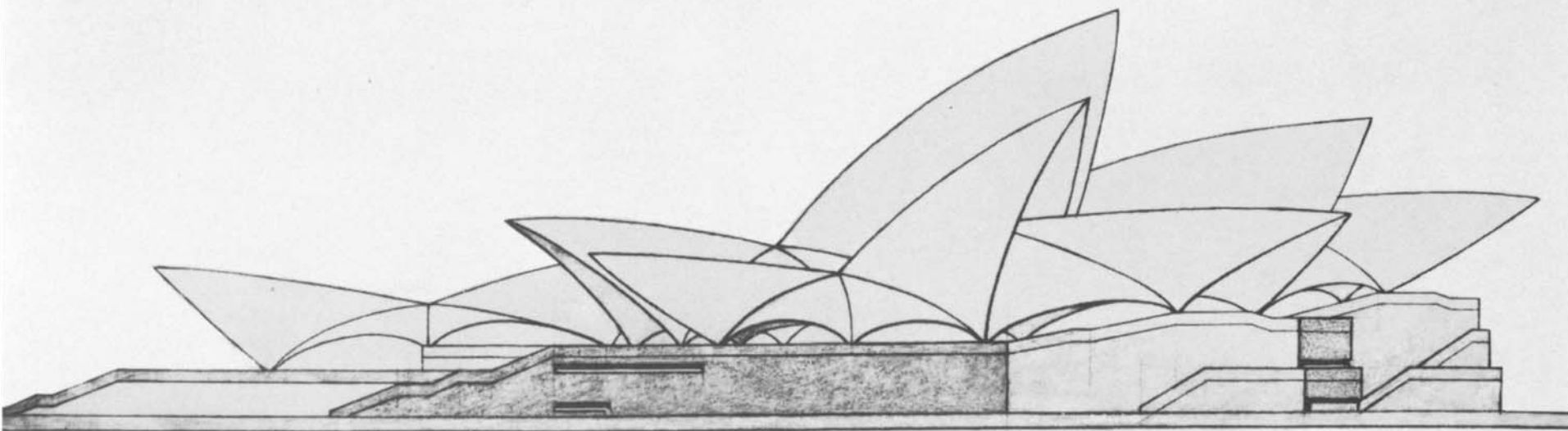

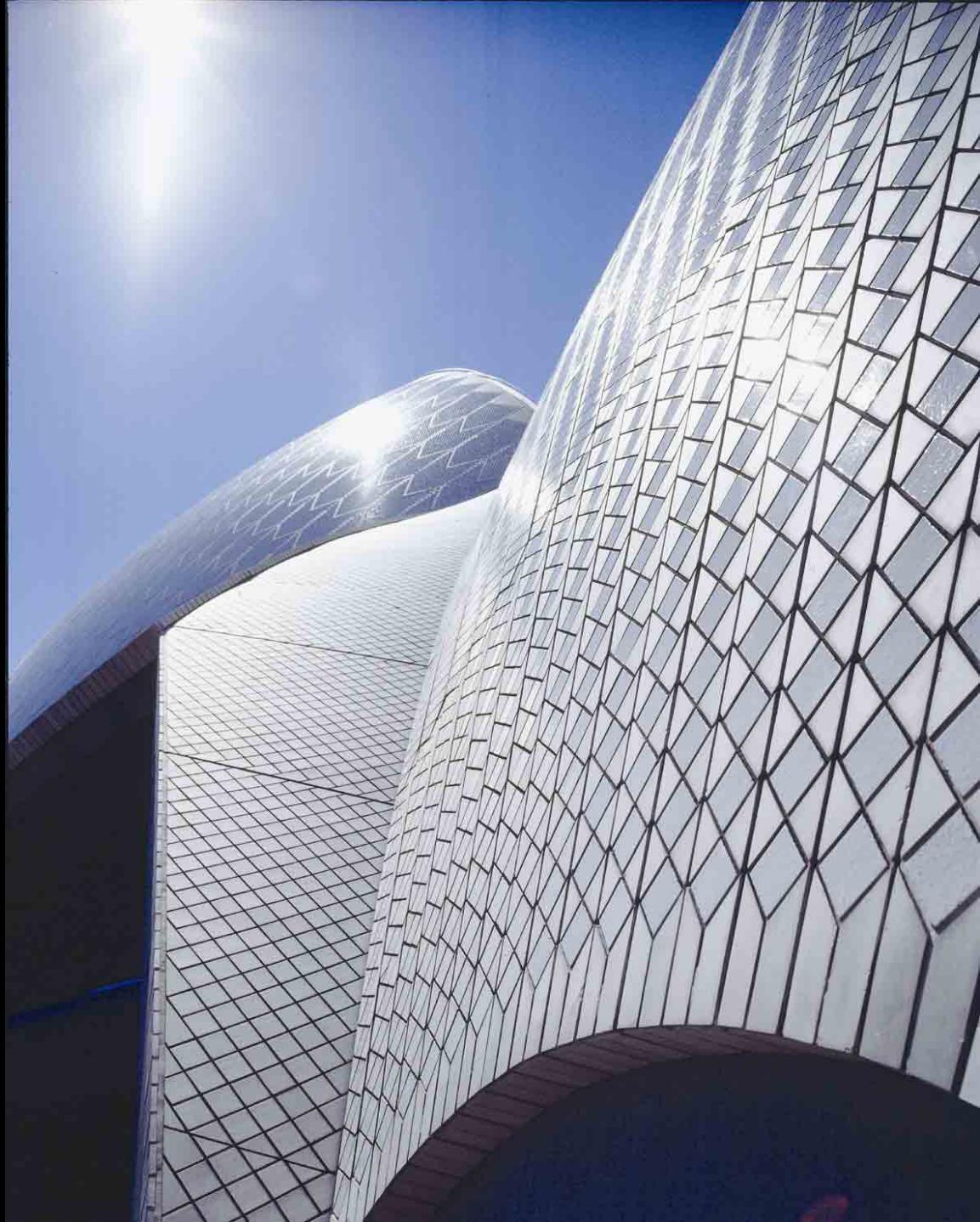







DOOR 7  
CIRCLE  
CIRCLE BOXES  
A.B.C.  
HARBOUR  
POTER  
TOILETS, BAR

DOOR 6  
STALLS  
ROWS  
N-X















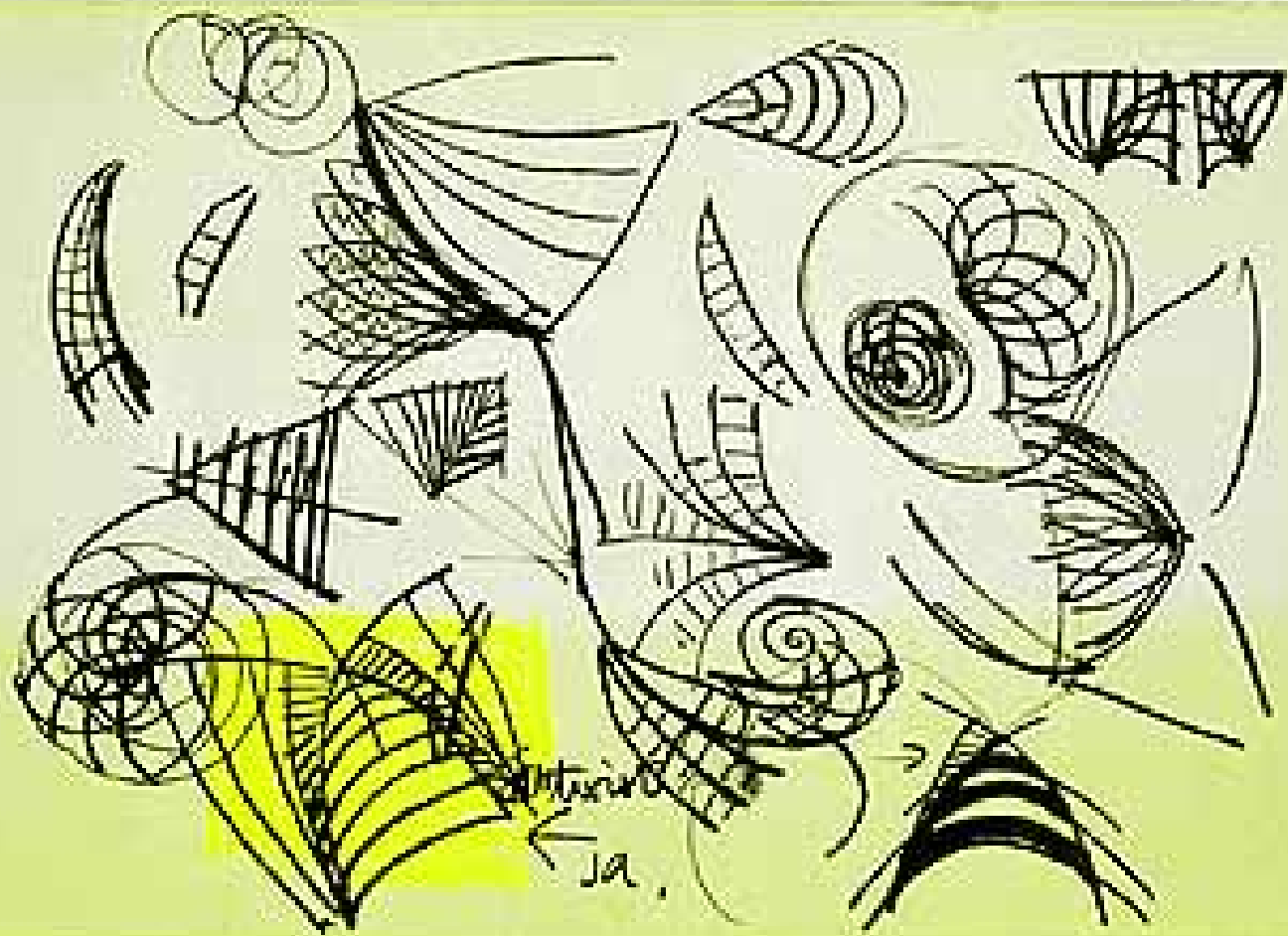

DOOR  
12  
STALLS  
NO  
ENTRY











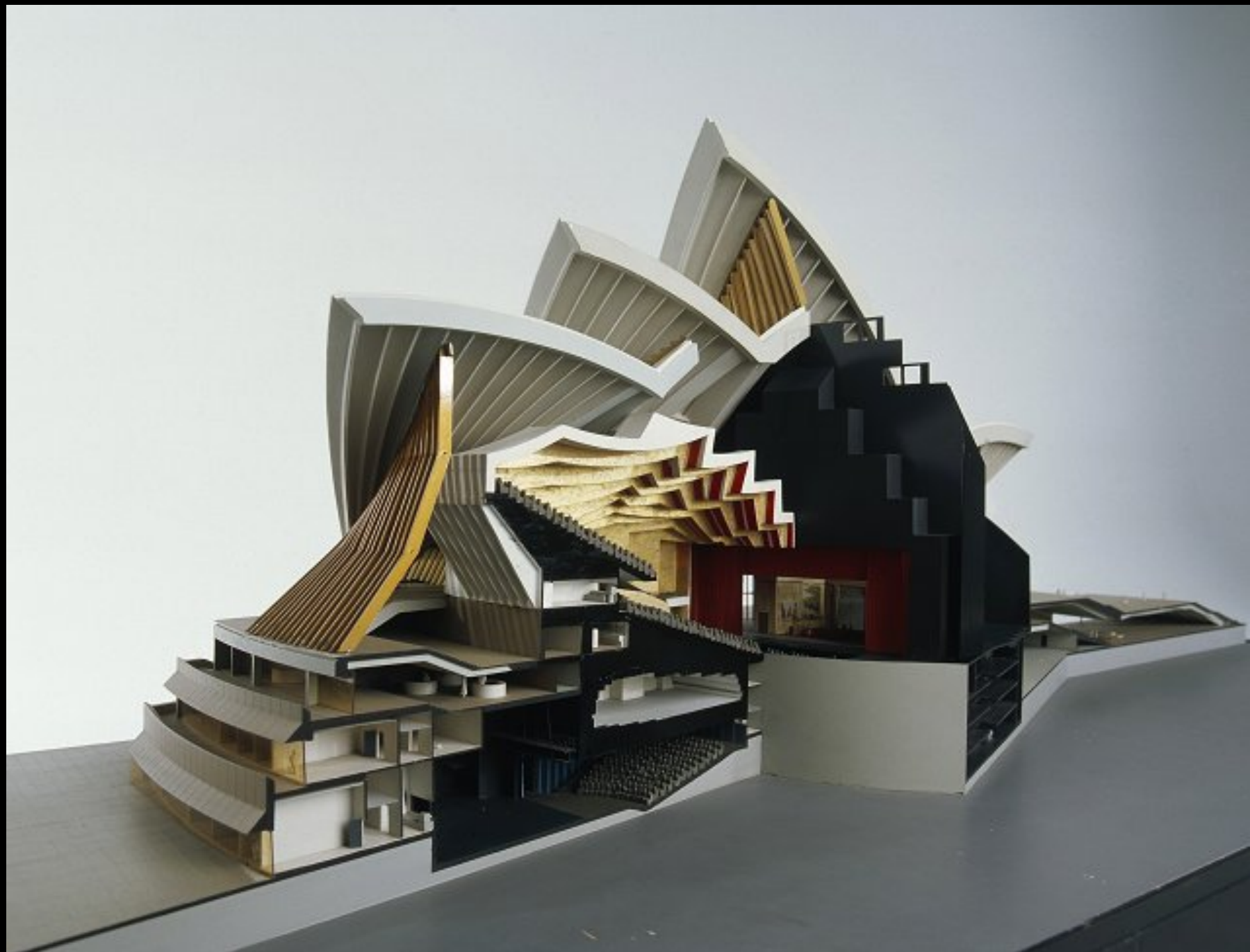









....how the process of engaging with the original designer has influenced, enriched and sustained the SOH as a heritage place....